

TRIESTE SHOWER FLOORS

NEO-CORNER, SQUARE, & RECTANGULAR MODELS

Our most popular series. Rectangular model with threshold on short dimension is designed especially for retro-fit situations. Wide integrally cast terrazzo threshold forms a perfect base for glass or plastic enclosure and saves the cost of a tiled threshold.



(Shown top to bottom) Models 43, 54, 88

FEATURES







- Terrazzo is cast in white Portland cement with a composition of black and white quartz, marble and other material chips, then ground smooth, grouted and sealed to resist stains and moisture which produces a compressive strength of 3000 PSI seven days after casting.
- Shower floors shall meet requirements CSA B45.8-18 / IAPMO Z403-2018.
- Terrazzo's natural non-slip surface provides better footing and increased safety.
- Stainless steel drain cast integral with removable stainless steel strainer, and sized for a gasket (QDC4000 included for 2" XHCI, plastic or steel pipe) or a caulked lead connection not less than 1" deep to a 3" pipe.
- Custom configurations available - Drain positions, overall sizes, color options. Call for more information and pricing.

OPTIONAL COMPONENTS

- ☐ **-PB:** Polished Brass Strainer
- ☐ **-VP:** Vandal Proof Drain

ORDERING OPTIONS

Part Number

4	5	6	8	8	9
					
Size (Neo-Corner)	Size (Square) Threshold on one side	Size (Square) Threshold on 2 adjacent sides	Size (Rectangular) Threshold on long dimension	Size (Rectangular) Threshold on long dimension	Size (Rectangular) Threshold on short dimension
<input type="checkbox"/> 2: 32x32 <input type="checkbox"/> 3: 34x34 <input type="checkbox"/> 4: 36x36 <input type="checkbox"/> 5: 38x38 <input type="checkbox"/> 6: 40x40	<input type="checkbox"/> 0: 30x30 <input type="checkbox"/> 2: 32x32 <input type="checkbox"/> 3: 34x34 <input type="checkbox"/> 4: 36x36 <input type="checkbox"/> 6: 40x40 <input type="checkbox"/> 7: 42x42 <input type="checkbox"/> 8: 48x48	<input type="checkbox"/> 2: 32x32 <input type="checkbox"/> 4: 36x36 <input type="checkbox"/> 6: 40x40	<input type="checkbox"/> 2: 36x32 <input type="checkbox"/> 3: 42x32 <input type="checkbox"/> 3.2: 42x34 <input type="checkbox"/> 3.5: 42x36 <input type="checkbox"/> 4: 48x32 <input type="checkbox"/> 4.2: 48x34 <input type="checkbox"/> 4.5: 48x36	<input type="checkbox"/> 6: 54x32 <input type="checkbox"/> 8: 60x32 <input type="checkbox"/> 8.2: 60x34 <input type="checkbox"/> 8.3: 60x30 <input type="checkbox"/> 8.5: 60x36	<input type="checkbox"/> 2: 32x36 <input type="checkbox"/> 4: 36x42 <input type="checkbox"/> 4.5: 36x48

DIMENSIONS

All dimensions subject to manufacturing variance of plus or minus 1/4" (6 mm)

MODEL	FLANGES	THRESHOLD	SIZE	A	B	C	D	E
42	2 sides	3 sides	32x32	32	32	12	14	25 3/8
43	2 sides	3 sides	34x34	34	34	12	14	24 1/8
44	2 sides	3 sides	36x36	36	36	12	17	27
45	2 sides	3 sides	38x38	38	38	12	19	26 7/8
46	2 sides	3 sides	40x40	40	40	12	20	28 1/4
50	3 sides	1 side	30x30	30	30	15	—	—
52	3 sides	1 side	32x32	32	32	16	—	—
53	3 sides	1 side	34x34	34	34	17	—	—
54	3 sides	1 side	36x36	36	36	18	—	—
56	3 sides	1 side	40x40	40	40	20	—	—
57	3 sides	1 side	42x42	42	42	21	—	—
58	3 sides	1 side	48x48	48	48	24	—	—
62	2 sides	2 sides	32x32	32	32	16	—	—
64	2 sides	2 sides	36x36	36	36	18	—	—
66	2 sides	2 side	40x40	40	40	20	—	—
82	3 sides	1 side	36x32	36	32	18	16	—
83	3 sides	1 side	42x32	42	32	21	16	—
83.2	3 sides	1 side	42x34	42	34	21	17	—
83.5	3 sides	1 side	42x36	42	36	21	18	—
84	3 sides	1 side	48x32	48	32	24	16	—
84.2	3 sides	1 side	48x34	48	34	24	17	—
84.5	3 sides	1 side	48x36	48	36	24	18	—
86	3 sides	1 side	54x32	54	32	27	16	—
88	3 sides	1 side	60x32	60	32	30	16	—
88.2	3 sides	1 side	60x34	60	34	30	17	—
88.3	3 sides	1 side	60x30	60	30	30	15	—
88.5	3 sides	1 side	60x36	60	36	30	18	—
92	3 sides	1 side	32x36	32	36	16	18	—
94	3 sides	1 side	36x42	36	42	18	21	—
94.5	3 sides	1 side	36x48	36	48	18	24	—

MODELS 42-46
NEO-CORNER

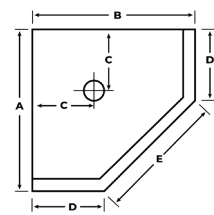

MODELS 50-58
THRESHOLD ON ONE SIDE

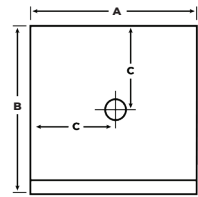

MODELS 62-66
THRESHOLD ON TWO ADJACENT SIDES

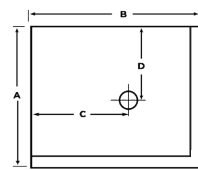

MODELS 82-88.5
THRESHOLD ON LONG DIMENSION

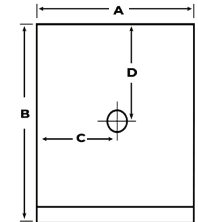

MODELS 92-94.5
THRESHOLD ON SHORT DIMENSION

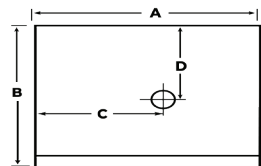

CROSS SECTION FOR ALL MODELS

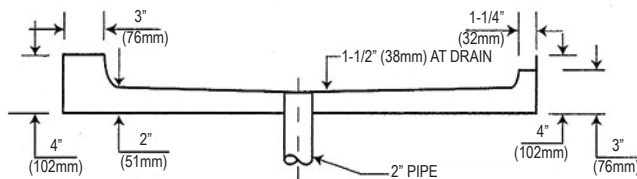

SPECS

Furnish and install Trieste shower floors with threshold manufactured by Stern-Williams using black and white chips cast in white Portland cement. The terrazzo material shall have a compressive strength not less than 3000 PSI after full cure. Shower floors shall meet requirements CSA B45.8-18 / IAPMO Z403-2018. All exposed terrazzo surfaces shall be ground smooth, grouted, and factory sealed to resist stains and moisture. Tiling flanges, cast integral shall be of stainless steel and shall not extend not less than one inch above the shoulder. Shoulder shall be not less than one and one-quarter inch wide. Shower floors include a stainless steel drain body that is cast integral to the shower floor with a removable type stainless steel strainer. Drain shall have inside connection to a 2" pipe sealed with factory provided gasket. Shall be made in the USA.