

2025 LIST PRICE BOOK
Mop Sinks & Shower Floors





ABOUT

Stern-Williams Products, LLC opened for business in 1962, beginning only with a few terrazzo mop sink models, which we have gradually expanded to include one of the most complete lines of precast plumbing products. Stern-Williams is a manufacturer of terrazzo mop sinks, shower floors and cabinet packages, and a complete line of drinking fountains, shower towers, bottle fillers and pet fountains.

MISSION

We specialize in custom solutions designed to fit your space, your specs and your needs. Stern-Williams strives to provide "A" quality services and products and is committed to be your best supplier. Our customer service is US-based with live support when you need it.

CONTACT

For more information about our products contact:

- orders@sternwilliams.com
- 800-323-2359
- sternwilliams.com

TERRAZZO

MOP SINKS // SHOWER FLOORS // ACCESSORIES



CUSTOM PRODUCTS

The Stern-Williams line of shower floors and mop sinks are great for any medical, multi-family, university, school or military applications. We also specialize in custom mop sinks and shower floors made to meet your specifications and requirements.

COLOR & MATERIALS

Our mop sinks and shower floors are made of terrazzo — a material composed of quartz and marble chips cast in white Portland cement. Our terrazzo products are then ground smooth, grouted and sealed to resist stains and moisture which produces a minimum comprehensive strength of 3000 PSI.

The standard color chip for mop basins are Gray and the standard for shower floors is Black and White. Contact Stern-Williams customer service for custom colors options.

STANDARD TERRAZZO COLORS

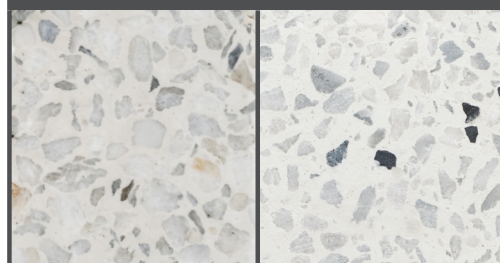

Mop Basins
White Portland
Cement with
Gray Chips

Shower Floors
White Portland
Cement with
Black & White
Chips

MOP SINKS: CORNER MODELS

Save space with the Crescent, Corlow, or Cornaro mop sinks from Stern-Williams. These corner models are popular for small spaces and are excellent for reducing interference from door swings.

CRESCENT

12" side walls with 6" drop front and stainless steel cap on threshold

MODEL	SIZE	A	B	C	SHIP WT.	LIST PRICE
CRS-2200	28x28x12	28	28	12	180 lbs. — 95 kg.	\$968.00
CRS-2202*	28x28x12	28	28	12	180 lbs. — 95 kg.	\$1,036.00

Plain shoulders w/o cap

*2 Tiling Flanges

CRS-2210	28x28x12	28	28	12	180 lbs. — 89 kg.	\$736.00
----------	----------	----	----	----	-------------------	----------

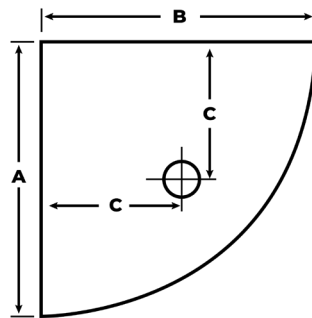

CORLOW

12" side walls with 6" drop front and stainless steel cap on threshold

MODEL	SIZE	A	B	C	D	E	SHIP WT.	LIST PRICE
SBC-1700	24x24x12	24	24	12	15	12 ½	215 lbs. — 98 kg.	\$874.00
SBC-1702*	24x24x12	24	24	12	15	12 ½	215 lbs. — 98 kg.	\$1,004.00
SBC-1725	32x32x12	32	32	12	23 ¼	12 ¼	370 lbs. — 168 kg.	\$968.00
SBC-1750	36x36x12	36	36	12	26	13 ½	414 lbs. — 188 kg.	\$1,072.00

*2 Tiling Flanges

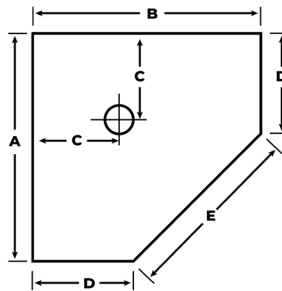

CORNARO

12" side walls and plain shoulders without caps

MODEL	SIZE	A	B	C	D	E	SHIP WT.	LIST PRICE
SBC-1400	24x24x12	24	24	12	15	12 ½	230 lbs. — 105 kg.	\$798.00
SBC-1402*	24x24x12	24	24	12	15	12 ½	230 lbs. — 105 kg.	\$930.00
SBC-1425	32x32x12	32	32	12	23 ¼	12 ¼	390 lbs. — 168 kg.	\$890.00
SBC-1450	36x36x12	36	36	12	26	13 ½	414 lbs. — 188 kg.	\$998.00

With CONTINUOUS one-piece stainless steel cap on shoulders

*2 Tiling Flanges

SBC-1500	24x24x12	24	24	12	15	12 ½	240 lbs. — 109 kg.	\$1,030.00
SBC-1502*	24x24x12	24	24	12	15	12 ½	240 lbs. — 109 kg.	\$1,098.00
SBC-1525	32x32x12	32	32	12	23 ¼	12 ¼	401 lbs. — 182 kg.	\$1,072.00
SBC-1550	36x36x12	36	36	12	26	13 ½	430 lbs. — 195 kg.	\$1,246.00

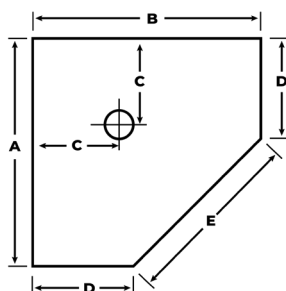

MOP SINKS: SQUARE OR RECTANGLE

The MTB series come in either a square or rectangle model with 10" high side walls. The MTB is popular when the job requires value engineering.

MTB®	MODEL	SIZE	A	B	C	D	SHIP WT.	LIST PRICE
Square	MTB-2424	24x24x10	24	24	12	—	214 lbs. — 97 kg.	\$510.00
Rectangular	MTB-3624	36x24x10	24	36	12	18	286 lbs. — 130 kg.	\$606.00

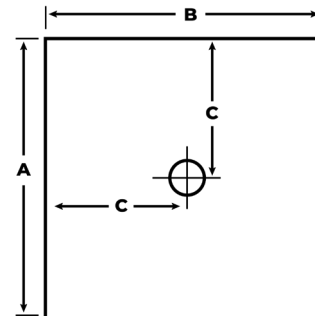
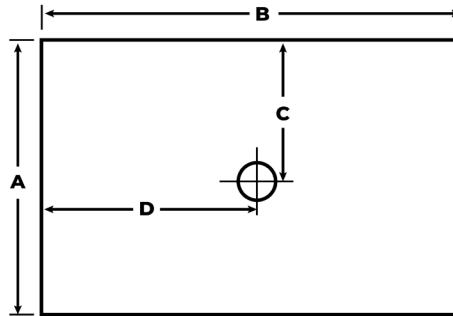

MOP SINKS: CORNER, SQUARE, OR RECTANGLE

The Elfin series come in corner, square or rectangular models with 6" high side walls.

ELFIN	MODEL	SIZE	A	B	C	D	E	SHIP WT.	LIST PRICE
Corner	EBC-150	36x36x6	36	36	12	17	27	267 lbs. — 121 kg.	\$698.00
Square	EB-54	24x24x6	24	24	12	—	—	145 lbs. — 66 kg.	\$638.00
	EB-66	30x30x6	30	30	15	—	—	229 lbs. — 104 kg.	\$660.00
	EB-70	32x32x6	32	32	16	—	—	250 lbs. — 114 kg.	\$680.00
	EB-78	36x36x6	36	36	18	—	—	287 lbs. — 130 kg.	\$692.00
Rectangular	EBR-66	36x24x6	24	36	12	18	—	214 lbs. — 97 kg.	\$660.00
	EBR-74	36x32x6	32	36	16	18	—	350 lbs. — 163 kg.	\$682.00

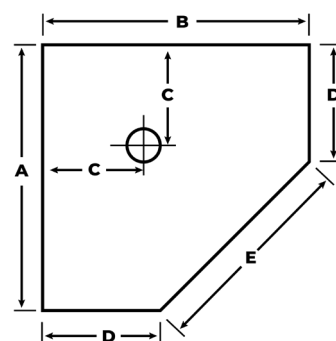
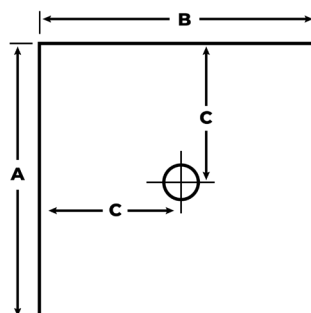
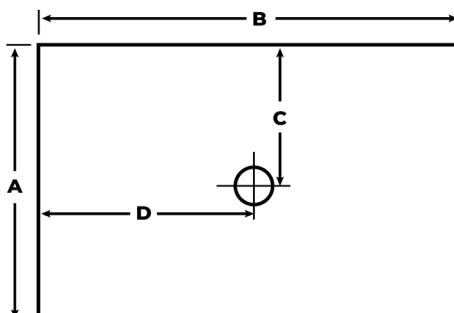

MOP SINKS: SQUARE OR RECTANGLE

The most complete line of terrazzo Serviceptors®. All models are available with plain shoulders or integral cast 20 gauge stainless steel caps with optional tiling flanges.

SERVICEPTOR®	MODEL	TILING FLANGES	SIZE	A	B	C	D	SHIP WT.	LIST PRICE
12" side walls with continuous one-piece stainless steel cap	SB-900	0	24x24x12	24	24	12	—	265 lbs. — 120 kg.	\$896.00
	SB-901	1	24x24x12	24	24	12	—	265 lbs. — 120 kg.	\$908.00
	SB-902	2	24x24x12	24	24	12	—	265 lbs. — 120 kg.	\$946.00
	SB-903	3	24x24x12	24	24	12	—	265 lbs. — 120 kg.	\$984.00
<i>*Flange is across back and on LEFT side on model numbers ending in "L"</i>	SB-700	0	32x32x12	32	32	16	—	367 lbs. — 166 kg.	\$1,178.00
	SB-701	1	32x32x12	32	32	16	—	367 lbs. — 166 kg.	\$1,198.00
	SB-702	2	32x32x12	32	32	16	—	358 lbs. — 162 kg.	\$1,246.00
	SB-703	3	32x32x12	32	32	16	—	360 lbs. — 163 kg.	\$1,290.00
<i>Flange is across back and on RIGHT side on model numbers ending in "R"</i>	SB-500	0	36x36x12	36	36	18	—	500 lbs. — 227 kg.	\$1,302.00
	SB-501	1	36x36x12	36	36	18	—	500 lbs. — 227 kg.	\$1,328.00
	SB-502	2	36x36x12	36	36	18	—	500 lbs. — 227 kg.	\$1,378.00
	SB-503	3	36x36x12	36	36	18	—	500 lbs. — 227 kg.	\$1,430.00
	SB-300	0	36x24x12	24	36	12	18	365 lbs. — 166 kg.	\$1,028.00
	SB-301	1	36x24x12	24	36	12	18	365 lbs. — 166 kg.	\$1,056.00
	SB-302-L*	2	36x24x12	24	36	12	18	365 lbs. — 166 kg.	\$1,420.00
	SB-302-R*	2	36x24x12	24	36	12	18	365 lbs. — 166 kg.	\$1,420.00
	SB-303	3	36x24x12	24	36	12	18	365 lbs. — 166 kg.	\$1,142.00

SERVICEPTOR®	MODEL	TILING FLANGES	SIZE	A	B	C	D	SHIP WT.	LIST PRICE
12" side walls without caps, plain shoulders	SB-800	0	24x24x12	24	24	12	—	265 lbs. — 120 kg.	\$754.00
	SB-801	1	24x24x12	24	24	12	—	265 lbs. — 120 kg.	\$884.00
	SB-802	2	24x24x12	24	24	12	—	265 lbs. — 120 kg.	\$926.00
	SB-803	3	24x24x12	24	24	12	—	265 lbs. — 120 kg.	\$970.00
<i>*Flange is across back and on LEFT side on model numbers ending in "L"</i>	SB-600	0	32x32x12	32	32	16	—	368 lbs. — 167 kg.	\$996.00
	SB-601	1	32x32x12	32	32	16	—	368 lbs. — 167 kg.	\$1,088.00
	SB-602	2	32x32x12	32	32	16	—	368 lbs. — 167 kg.	\$972.00
	SB-603	3	32x32x12	32	32	16	—	368 lbs. — 167 kg.	\$1,018.00
<i>Flange is across back and on RIGHT side on model numbers ending in "R"</i>	SB-400	0	36x36x12	36	36	18	—	500 lbs. — 227 kg.	\$1,100.00
	SB-401	1	36x36x12	36	36	18	—	500 lbs. — 227 kg.	\$1,108.00
	SB-402	2	36x36x12	36	36	18	—	500 lbs. — 227 kg.	\$1,080.00
	SB-403	3	36x36x12	36	36	18	—	500 lbs. — 227 kg.	\$1,130.00
	SB-200	0	36x24x12	24	36	12	18	365 lbs. — 166 kg.	\$872.00
	SB-201	1	36x24x12	24	36	12	18	365 lbs. — 166 kg.	\$912.00
	SB-202-L*	2	36x24x12	24	36	12	18	365 lbs. — 166 kg.	\$1,182.00
	SB-202-R*	2	36x24x12	24	36	12	18	365 lbs. — 166 kg.	\$1,182.00
	SB-203	3	36x24x12	24	36	12	18	365 lbs. — 166 kg.	\$998.00

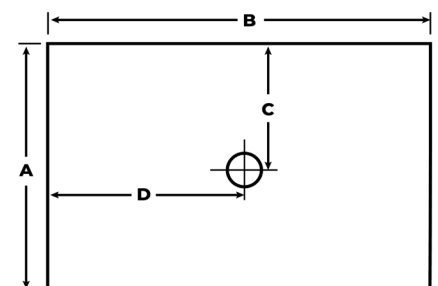
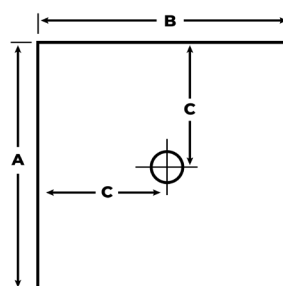
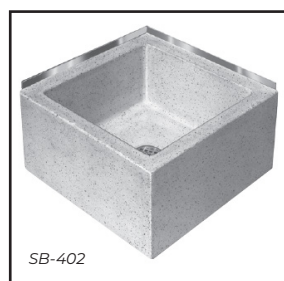
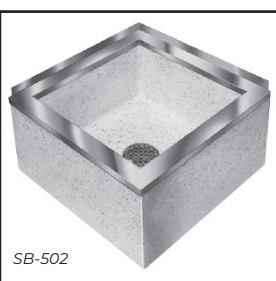

SERVICEPTOR®	MODEL	TILING FLANGES	SIZE	A	B	C	D	SHIP WT.	LIST PRICE
12" side walls with four stainless steel caps	SB-850	0	24x24x12	24	24	12	—	265 lbs. — 120 kg.	\$896.00
	SB-650	0	32x32x12	32	32	16	—	367 lbs. — 166 kg.	\$956.00
	SB-450	0	36x36x12	36	36	18	—	500 lbs. — 227 kg.	\$1,312.00
	SB-250	0	36x24x12	24	36	12	18	365 lbs. — 166 kg.	\$1,036.00

MOP SINKS: SQUARE OR RECTANGLE

The 12" side walls with a 6" drop front makes it easy to dump waste water. The HILOW series have the stainless steel cap cast into the threshold to protect the area of greatest use or is also available with caps on all horizontal shoulders.

HILOW	MODEL	SIZE	A	B	C	D	SHIP WT.	LIST PRICE
Stainless steel cap on threshold	HL-1800	24x24x12	24	24	12	—	237 lbs. — 108 kg.	\$810.00
	HL-1900	32x32x12	32	32	16	—	349 lbs. — 158 kg.	\$864.00
	HL-2000	36x36x12	36	36	18	—	430 lbs. — 195 kg.	\$1,018.00
	HL-2100	36x24x12	24	36	12	18	312 lbs. — 142 kg.	\$836.00
Stainless steel cap on all shoulders	HL-1810	24x24x12	24	24	12	—	237 lbs. — 108 kg.	\$940.00
	HL-1910	32x32x12	32	32	16	—	349 lbs. — 158 kg.	\$1,022.00
	HL-2010	36x36x12	36	36	18	—	430 lbs. — 195 kg.	\$1,190.00
	HL-2110	36x24x12	24	36	12	18	312 lbs. — 142 kg.	\$988.00

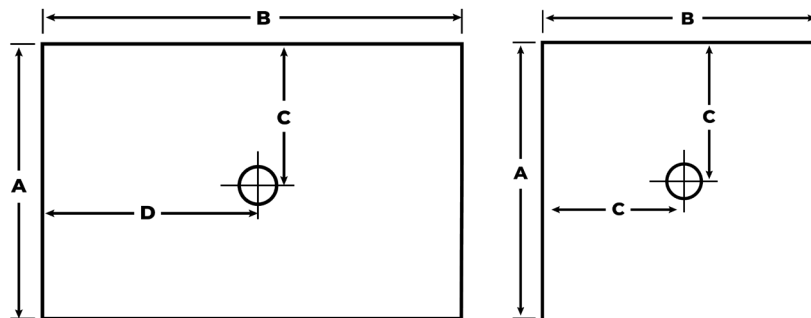

STAINLESS STEEL MOP SINK: SQUARE

This 24x24 stainless steel mop basin provides ample space for all mop cleaning needs. Only weighing 50 lbs, it can easily be installed by one person. Includes sound reducing insulation on all enclosed sides.

MODEL	SIZE	A	B	C	SHIP WT.	LIST PRICE
SS-2424	24x24x13-1/4"	24	24	12	50 lbs. — 22 kg.	\$1,288.00

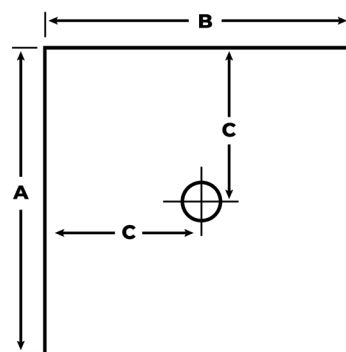

SHOWER FLOORS: CORNER, SQUARE, RECTANGLE

The Serpentine and Sussex shower floors are available in square, rectangular, and corner models. All models can be customized to fit space and drain specifications.

SUSSEX	MODEL	FLANGES	SIZE	A	B	C	D	E	SHIP WT.	LIST PRICE
Neo-corner	14	All Sides	36x36	36	36	12	17	27	215 lbs. — 98 kg.	\$826.00
	16	All Sides	40x40	40	40	12	20	28 ¼	247 lbs. — 112 kg.	\$874.00
Square	22	All Sides	32x32	32	32	16	16	—	197 lbs. — 89 kg.	\$810.00
	24	All Sides	36x36	36	36	18	18	—	249 lbs. — 113 kg.	\$836.00
	24-BO	All Sides	36x36	36	36	—	—	—	250 lbs. — 114 kg.	\$1,036.00
	26	All Sides	40x40	40	40	20	20	—	306 lbs. — 139 kg.	\$894.00
Rectangle	32	All Sides	48x32	48	32	24	16	—	335 lbs. — 152 kg.	\$872.00

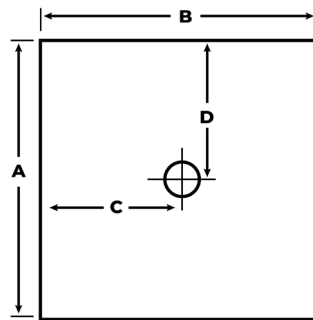

SERPENTINE

Specify: Plain curbs

Add suffix for: Flanges (-F: 1, 2 or 3), or Rabbets (-R: specify configuration)

	34	36x36	36	36	18	18	—	395 lbs. — 179 kg.	\$958.00
	34.5	48x36	36	48	24	18	—	490 lbs. — 222 kg.	\$1,672.00
Drain is centered on back dimension	34-BO	36x36	36	36	18*	—	—	388 lbs — 176 kg.	\$1,298.00
Neo-corner	34-NC	36x36	36	36	12	18	25 ¾	355 lbs. — 161 kg.	\$1,108.00
Single Drain	36-D	36x72	36	72	36	18	—	780 lbs. — 354 kg.	\$1,548.00
Double Drain	36-DD	36x72	36	72	18	—	—	735 lbs — 353 kg.	\$1,576.00

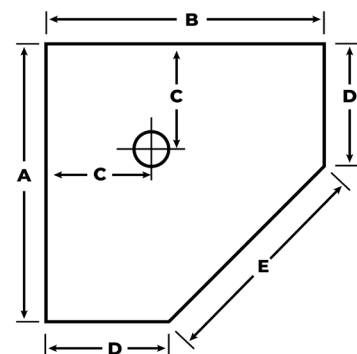
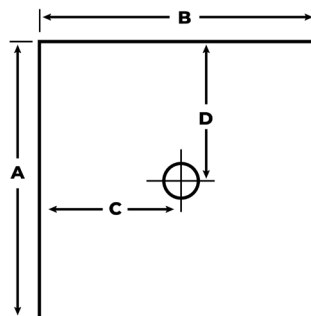
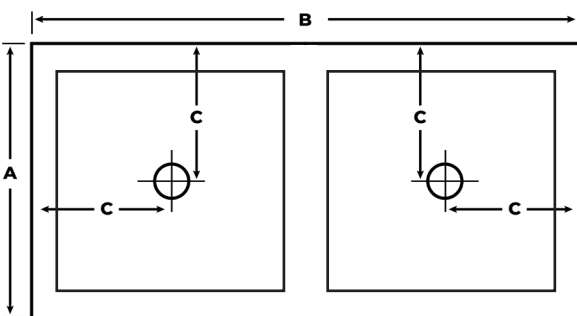
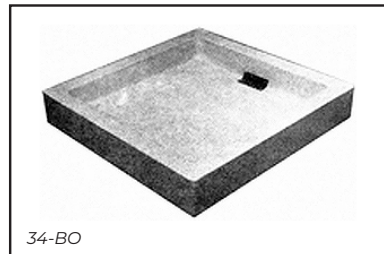

SHOWER FLOORS: CORNER, SQUARE, RECTANGLE

The Trieste Shower Floor line comes with square, rectangular, and corner models. All models can be customized to fit space and drain specifications.

TRIESTE	MODEL	FLANGES	THRESHOLD	SIZE	A	B	C	D	E	SHIP WT.	LIST PRICE
Neo-corner	42	2 sides	3 sides	32x32	32	32	12	14	25 ¾	190 lbs. — 86 kg.	\$758.00
	43	2 sides	3 sides	34x34	34	34	12	14	24 ½	210 lbs. — 95 kg.	\$786.00
	44	2 sides	3 sides	36x36	36	36	12	17	27	230 lbs. — 105 kg.	\$802.00
	45	2 sides	3 sides	38x38	38	38	12	19	26 ⅞	275 lbs. — 125 kg.	\$850.00
	46	2 sides	3 sides	40x40	40	40	12	20	28 ¼	265 lbs. — 120 kg.	\$850.00
Square	50	3 sides	1 side	30x30	30	30	15	—	—	180 lbs. — 82 kg.	\$788.00
	52	3 sides	1 side	32x32	32	32	16	—	—	205 lbs. — 93 kg.	\$808.00
	52-BO*	3 sides	1 side	32x32	32	32	16	—	—	205 lbs. — 93 kg.	\$1,074.00
	53	3 sides	1 side	34x34	34	34	17	—	—	225 lbs. — 102 kg.	\$828.00
	54	3 sides	1 side	36x36	36	36	18	—	—	250 lbs. — 113 kg.	\$844.00
	54-BO*	3 sides	1 side	36x36	36	36	18	—	—	250 lbs. — 113 kg.	\$1,122.00
	56	3 sides	1 side	40x40	40	40	20	—	—	285 lbs. — 130 kg.	\$904.00
	57	3 sides	1 side	42x42	42	42	21	—	—	365 lbs. — 166 kg.	\$938.00
Square with threshold on 2 sides	58	3 sides	1 side	48x48	48	48	24	—	—	425 lbs. — 193 kg.	\$1,048.00
	62	2 sides	2 sides	32x32	32	32	16	—	—	220 lbs. — 100 kg.	\$788.00
	64	2 sides	2 sides	36x36	36	36	18	—	—	255 lbs. — 116 kg.	\$820.00
Rectangle with threshold on long dimension	66	2 sides	2 sides	40x40	40	40	20	—	—	285 lbs. — 130 kg.	\$876.00
	82	3 sides	1 side	36x32	36	32	18	16	—	240 lbs. — 109 kg.	\$824.00
	83	3 sides	1 side	42x32	42	32	21	16	—	255 lbs. — 116 kg.	\$884.00
	83.2	3 sides	1 side	42x34	42	34	21	17	—	275 lbs. — 124 kg.	\$882.00
	83.5	3 sides	1 side	42x36	42	36	21	18	—	300 lbs. — 136 kg.	\$890.00
	84	3 sides	1 side	48x32	48	32	24	16	—	285 lbs. — 130 kg.	\$898.00
	84.2	3 sides	1 side	48x34	48	34	24	17	—	315 lbs. — 143 kg.	\$900.00
	84.5	3 sides	1 side	48x36	48	36	24	18	—	335 lbs. — 152 kg.	\$906.00
	86	3 sides	1 side	54x32	54	32	27	16	—	335 lbs. — 152 kg.	\$934.00
	88	3 sides	1 side	60x32	60	32	30	16	—	385 lbs. — 175 kg.	\$962.00
	88.2	3 sides	1 side	60x34	60	34	30	17	—	395 lbs. — 180 kg.	\$968.00
Rectangle with threshold on short dimension	88.3	3 sides	1 side	60x30	60	30	30	15	—	370 lbs. — 168 kg.	\$954.00
	88.5	3 sides	1 side	60x36	60	36	30	18	—	420 lbs. — 191 kg.	\$982.00
	92	3 sides	1 side	32x36	32	36	16	18	—	235 lbs. — 107 kg.	\$820.00
Rectangle with threshold on short dimension	94	3 sides	1 side	36x42	36	42	18	21	—	300 lbs. — 136 kg.	\$886.00
	94.5	3 sides	1 side	36x48	36	48	18	24	—	335 lbs. — 152 kg.	\$924.00

*Drain is centered on back dimension, 2" FIPS outlet

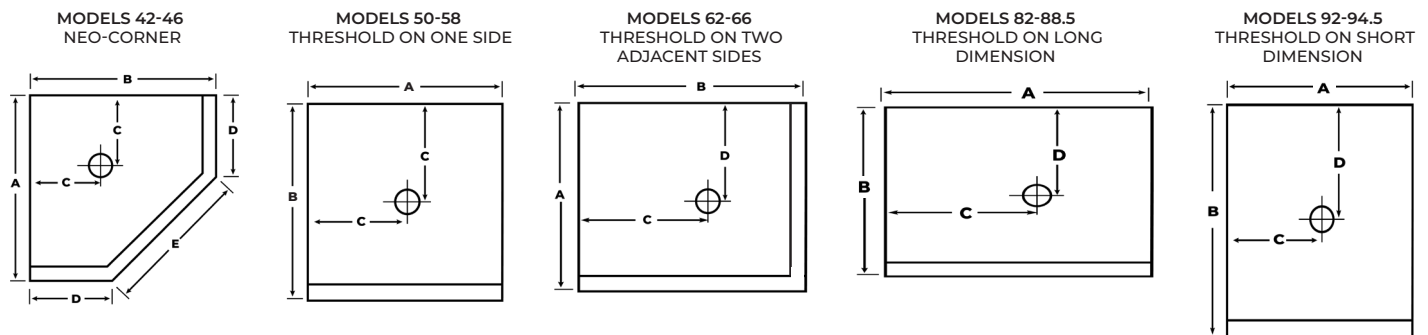

SHOWER FLOORS: SQUARE OR RECTANGLE

Stern-Williams offers an extensive line of shower floors for the physically challenged. Select models include a 6" integral ramp while others are reduced into the threshold for easy wheelchair access.

PARIAN	MODEL	FLANGES	RAMP	SIZE	A	B	C	D	E	F	SHIP WT.	LIST PRICE
Roll-in type shower floor	WDA-3400	3 sides	—	39x39	39	39	19	20	—	—	345 lbs. — 156 kg.	\$1,128.00
	WDA-3410	3 sides	—	60x30	60	30	15	30	—	—	433 lbs. — 196 kg.	\$1,680.00
	WDA-3420	3 sides	—	60x36	60	36	18	30	—	—	472 lbs. — 214 kg.	\$1,650.00
Transfer shower floor with ramp	WDA-3600	3 sides	1 side	39x39	39	39	19 ½	19 ½	26	12	342 lbs. — 155 kg.	\$1,184.00
	WDA-3610	3 sides	1 side	60x30	60	30	15	30	18	12	402 lbs. — 182 kg.	\$1,734.00
	WDA-3620	3 sides	1 side	60x36	60	36	18	30	24	12	445 lbs. — 202 kg.	\$1,528.00

Flanges are intended to be used with wall tile applied by others to conform with Federal, state, and local shower stall dimensions.

Floors can be supplied less flanges (-LF). Optional Collapsible Dam (RDM) for HC, WDA and WS Series shower bases.



SERPENTINE	MODEL	FLANGES	RAMP	SIZE	A	B	C	D	E	F	SHIP WT.	LIST PRICE
Wheelchair shower floor with reduced threshold	WH-2200	3 sides	—	36x36	36	36	18	18	—	—	330 lbs. — 149 kg.	\$984.00
	WH-2400*	3 sides	—	40x40	40	40	20	20	—	—	383 lbs. — 74 kg.	\$1,508.00
	WH-2500	3 sides	—	42x42	42	42	21	21	—	—	400 lbs. — 182 kg.	\$1,170.00
	WH-2600	3 sides	—	48x36	48	36	18	24	—	—	432 lbs. — 196 kg.	\$1,160.00
	WH-2700	3 sides	—	48x48	48	48	24	24	—	—	500 lbs. — 227 kg.	\$1,424.00
	WH-2800	3 sides	—	60x32	60	32	16	30	—	—	458 lbs. — 208 kg.	\$2,056.00
	WH-2900	3 sides	—	60x34	60	34	17	30	—	—	479 lbs. — 217 kg.	\$1,334.00
	WH-3000	3 sides	—	46x52	46	52	8	23	—	—	510 lbs. — 232 kg.	\$1,304.00
Wheelchair shower floor with 6" stainless steel cap on integral ramp	WS-3200	3 sides	1 side	36x36	36	36	12	18	24	12	330 lbs. — 150 kg.	\$1,104.00
	WS-3500	3 sides	1 side	48x48	48	48	18	24	36	12	565 lbs. — 257 kg.	\$1,586.00
	WS-3501	3 sides	1 side	60x48	60	48	18	30	36	12	690 lbs. — 313 kg.	\$1,906.00
	WS-3502	3 sides	1 side	60x60	60	60	24	30	48	12	845 lbs. — 384 kg.	\$1,990.00
	WS-3503	3 sides	1 side	42x70	42	70	9	21	58	12	690 lbs. — 313 kg.	\$1,936.00
	WS-3504	3 sides	1 side	48x70	48	70	9	24	58	12	831 lbs. — 377 kg.	\$1,978.00
	WS-3505	3 sides	1 side	60x70	60	70	9	30	58	12	973 lbs. — 441 kg.	\$2,264.00

* ADA Transfer Style

** ADA Roll-In Style

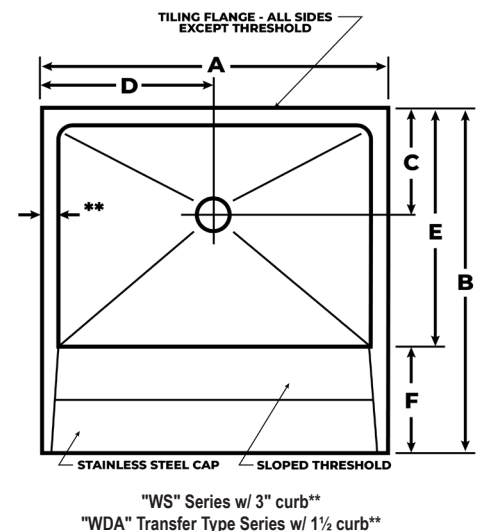
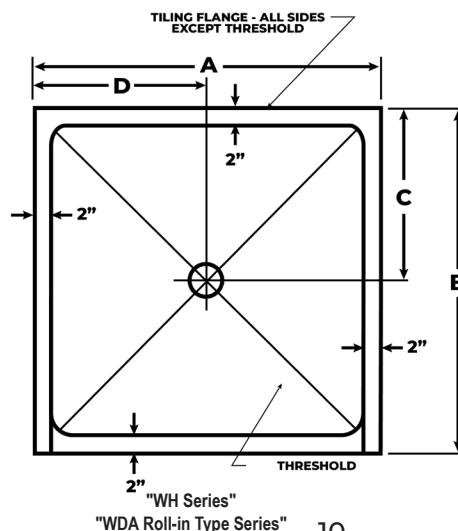
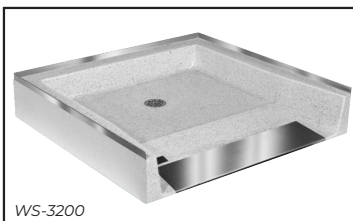

SHOWER FLOORS: SQUARE OR RECTANGLE

The Pentelic Series are designed to accommodate physically challenged users. Select models include a 6" integral ramp while others are reduced into the threshold for easy wheelchair access. Optional Collapsible Dam (RDM) for HC, WDA and WS Series shower bases.

PENTELIC	MODEL	FLANGES	RAMP	SIZE	A	B	C	D	E	F	SHIP WT.	LIST PRICE
Standard drain with reduced threshold	WDA-3405	3 sides	—	40x38	40	38	19 ½	19 ½	—	—	330 lbs. — 150 kg.	\$1,128.00
	WDA-3430**	3 sides	—	64x32	64	32	16	32	—	—	460 lbs. — 209 kg.	\$1,658.00
	WDA-3460**	3 sides	—	64x38	64	38	19	32	—	—	557 lbs. — 253 kg.	\$1,736.00
Linear drain with 6" stainless steel grate	WDA-3705*	3 sides	—	40x38	40	38	34	20	36	36	445 lbs. — 202 kg.	\$1,458.00
	WDA-3730**	3 sides	—	64x32	64	32	28	32	60	30	460 lbs. — 209 kg.	\$2,112.00
	WDA-3760**	3 sides	—	64x38	64	38	34	32	60	36	705 lbs. — 320 kg.	\$2,202.00
Standard drain with 6" stainless steel cap on integral ramp	WDA-3605	3 sides	1 side	40x38	40	38	12	19 ½	27	12	342 lbs. — 155 kg.	\$1,218.00
	WDA-3630	3 sides	1 side	64x32	64	32	12	32	20	12	445 lbs. — 202 kg.	\$1,664.00
	WDA-3660	3 sides	1 side	64x38	64	38	12	32	26	12	565 lbs. — 256 kg.	\$1,756.00

*ADA Transfer Style

**ADA Roll-In Style

Optional Collapsible Dam (RDM) for HC, WDA and WS Series shower bases.

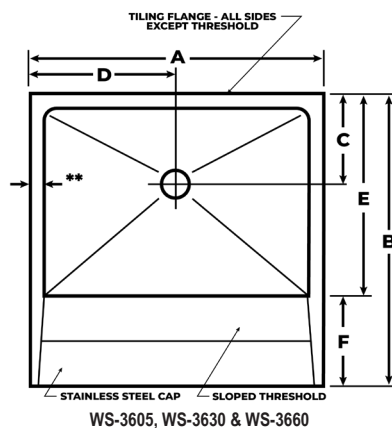
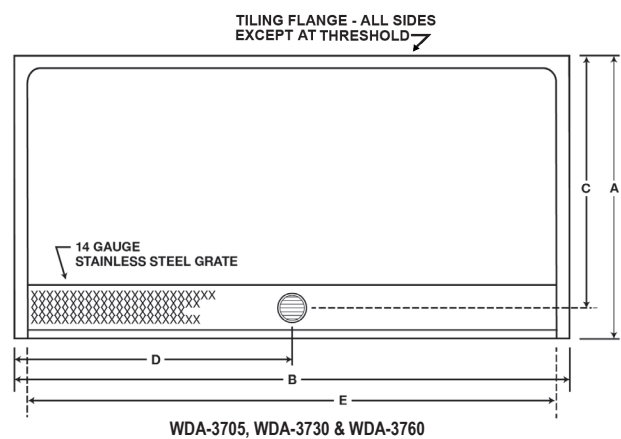
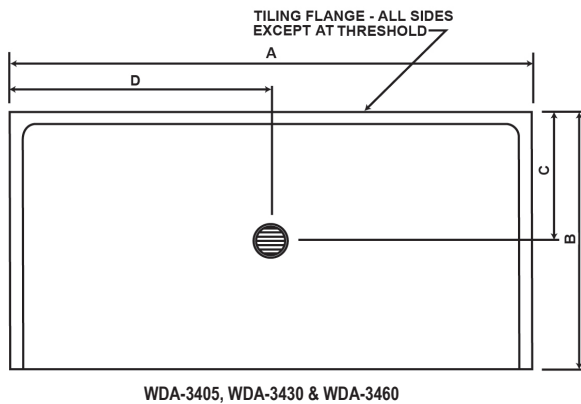
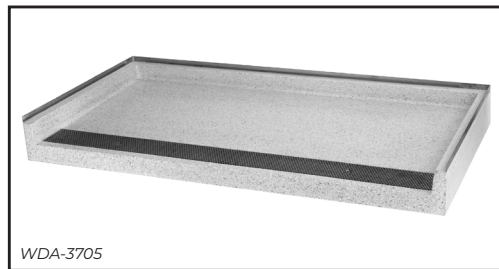

SHOWER CABINETS

Free standing shower cabinet packages for single or multiple unit installations. HSC models include a ramp or roll-in terrazzo shower floor and pressure balance valve with separate stops. We suggest a floor drain at the entrance to the transfer type (not included).

HSC HANDICAP SHOWER CABINETS

	MODEL	RAMP	SIZE	SHIP WT.	LIST PRICE
Roll-in type	HSC-400	—	40X40X82	510 lbs. — 231 kg.	\$6,636.00
	*HSC-430	—	65x33x82	800 lbs. — 363 kg.	\$8,392.00
	*HSC-460	—	65x39x82	915 lbs. — 415 kg.	\$8,916.00
Transfer type	HSC-143	1 side	40x40x82	560 lbs. — 255 kg.	\$7,274.00
	HSC-145	1 side	40x48x82	750 lbs. — 340 kg.	\$7,848.00
	*HSC-630	1 side	65x33x82	850 lbs. — 386 kg.	\$8,698.00
	*HSC-660	1 side	65x39x82	975 lbs. — 442 kg.	\$9,252.00

Optional Collapsible Dam (RDM) for HC, WDA and WS Series shower bases.

Standard Equipment on HSC units includes: Terrazzo shower floor, SC-140-SS pressure balanced valve, with separate stops. Hand held shower head with swivel fitting, 69" flexible C.P. brass hose, and in line vacuum breaker. Stainless steel curtain rod, 10-oz. GSA approved curtain. Retractable shower seat with stainless steel frame. One wrap around and one vertical stainless steel grab bar. Standard finish is white powder coat. Optional finishes: Stainless Steel, High Density Polymer, and Solid Phenolic Core. ***Add -B to the end of the model number for base only.**

SPECIAL ORDERS & OPTIONS

	DESCRIPTION	DEDUCT	ALL
HSC Model	Omission of Valve and Head	Call	—
<i>Options on all Models</i>			
HSC-TC	Top only	—	Call
HSC-TCLF-430	Top and dome light		\$1,563.94
HSC-TCLF-460	Top and dome light	—	\$1,713.47
SC-6	Filler strip - front	—	\$334.00
SC-7	Filler strip - back	—	\$300.00
SC-JFS (layout sketch required)	Joint filler strip	—	\$334.00
-FB (Layout sketch required)	Filler block	—	Call
SC-140-TCVH	Thermostatic Valve	—	\$2,833.33
-DC (Layout sketch required)	Attached dressing compartment	—	Call
-SS	Stainless steel walls	—	Call
-SPC	Solid phenolic core walls	—	Call
-HDP	High density polymer walls	—	Call
-RDM	Collapsible dam	—	Call

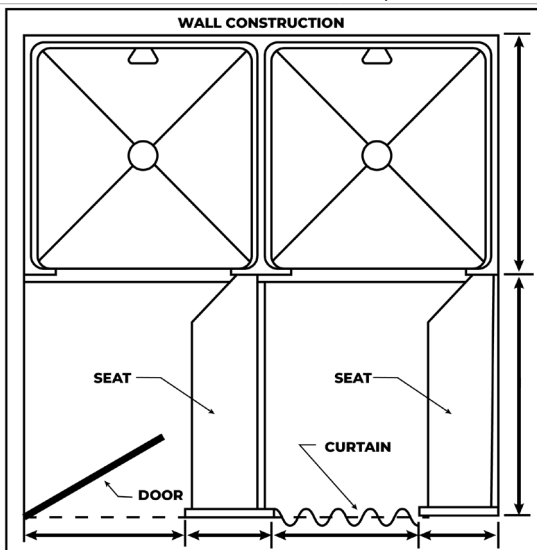
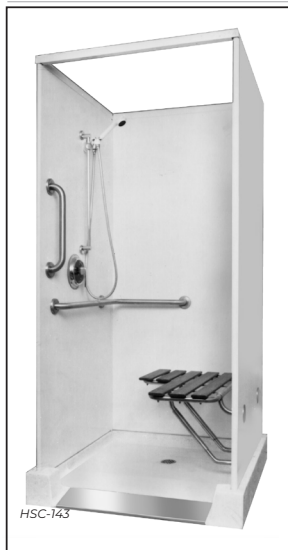

SHOWER CABINETS

Standard Equipment on SC units includes: Terrazzo shower floor, S-140 pressure balanced valve and head, soap dish, rod and curtain. Standard finish is white powder coat. Optional finishes: Stainless Steel, High Density Polymer and Solid Phenolic Core.

SC SHOWER CABINETS	MODEL	SIZE	SHIP WT.	LIST PRICE
Front entry	SC-32	32x32x82	475 lbs. — 216 kg.	\$4,492.00
	SC-36	36x36x82	540 lbs. — 246 kg.	\$3,882.00
Double entrance walk through	SC-38	36x36x82	530 lbs. — 241 kg.	\$3,886.00
Double entrance corner opening	SC-39	36x36x82	530 lbs. — 241 kg.	\$3,788.00
Neo-Corner	SC-40	40x40x82	575 lbs. — 261 kg.	\$4,018.00

NOTE: Specify R or L hand valve drilling

SPECIAL ORDERS & OPTIONS	DESCRIPTION	DEDUCT	ALL
SC Model	Omission of Valve and Head	Call	—
<i>Options on all Models</i>			
SC-TC-36	Top only	—	\$702.00
SC-TCLF-32	Top and dome light	—	\$848.00
SC-TCLF-36	Top and dome light	—	\$926.00
SC-7	Filler strip - back	—	\$300.00
SC-JFS	Joint filler strip	—	\$334.00
-FB (Layout sketch required)	Filler block	—	Call
SC-140-TCVH	Thermostatic Valve	—	\$2,833.33
-DC (Layout sketch required)	Attached dressing compartment	—	Call
-SS	Stainless steel walls	—	Call
-SPC	Solid phenolic core walls	—	Call
-HDP	High density polymer walls	—	Call

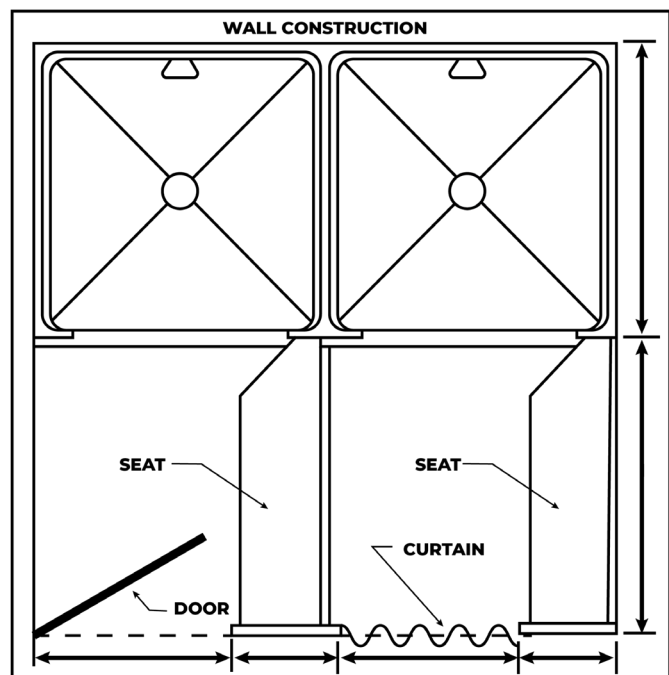

ACCESSORIES

DRAIN GASKETS

	GASKET FOR BRASS DRAIN	LIST PRICE	=	GASKET FOR SS DRAIN	SHIP WT.	LIST PRICE
2" Drain Gasket for 2" pipe	TC-2	\$14.23		QDC4000	1 lbs. — .5 kg.	\$4.62
2" Drain Gasket for 2" Pipe - No Hub	—	—		QIC2000		\$5.74
3" For XHCl, plastic and steel pipe	TC-3	\$21.95		QDC3XH000		\$7.14
3" For SV and NCHl pipe	TC-3-NH	\$21.85		QDC3SN000		\$29.40
3" Reducer with 2" hole	TC-3-2	\$28.00		QDC32000		\$13.86

TC fits brass drains only!

Use only with STERN-WILLIAMS shower floors and mop sinks.

STRAINERS

	STRAINERS FOR BRASS DRAIN	LIST PRICE	=	STRAINERS FOR SS DRAIN	SHIP WT.	LIST PRICE
2" Stainless Steel Strainer	S423-0056	\$8.21		S423-0105	1 lbs. — .5 kg.	\$5.97
3" Stainless Steel Dome Strainer	S423-0002	\$17.76		S423-0106		\$15.70
3" Stainless Steel Flat Strainer	S423-0001	\$7.60		S423-0107		\$15.83

Use only with STERN-WILLIAMS shower floors and mop sinks.

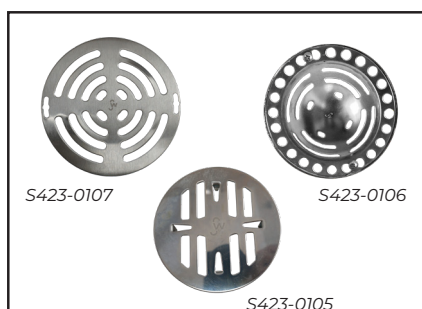
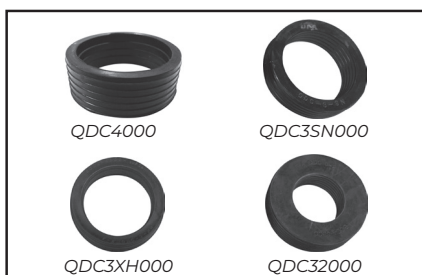

DESCRIPTION	MODEL	SHIP WT.	LIST PRICE
SPLASH CATCHER® WALL GUARDS			
SINGLE PANEL			
24"	BP-1-24	6 lbs. — 3 kg.	\$66.00
28"	BP-1-28		\$182.00
30"	BP-1-30		\$182.00
32"	BP-1-32		\$194.00
36"	BP-1-36		\$194.00
TWO PANELS, ONE CORNER			
24"	BP-2-24	10 lbs. — 5 kg.	\$188.00
24" wide x 36" wide	BP-2-2436		\$262.00
28"	BP-2-28		\$254.00
30"	BP-2-30		\$558.00
32"	BP-2-32		\$268.00
36"	BP-2-36		\$284.00
THREE PANELS, TWO CORNERS			
24"	BP-3-24	15 lbs. — 7 kg.	\$240.00
24" wide x 36" wide	BP-3-2436		\$846.00
28"	BP-3-28		\$962.00
30"	BP-3-30		\$972.00
32"	BP-3-32		\$990.00
36"	BP-3-36		\$1,018.00
STAINLESS STEEL CORNER			
Corner	BP-Corner		\$114.00

DESCRIPTION	MODEL	SHIP WT.	LIST PRICE
SERVICE FAUCET			
With integral stops, lever handles, and spring checks. Spout with bucket hook and 3/4" hose thread end. Vacuum breaker and adjustable top brace. Inlets 8" on center. <i>Rough Chrome Finish.</i>	T-10-VB	7 lbs. — 3 kg.	\$198.00
Same as above, with <i>Polished Chrome Finish.</i>	T-15-VB	7 lbs. — 3 kg.	\$318.00

ACCESSORIES



CLINIC SINK BASE	MODEL	SIZE	SHIP WT.	LIST PRICE
	1028	28x14x10	115 lbs. — 52 kg.	\$714.00



DESCRIPTION	MODEL	SHIP WT.	LIST PRICE
HOSE & WALL BRACKET			
30" long hose with chrome coupling & stainless steel wall bracket	T-35	1 lb. — .5 kg.	\$62.00
Same as above, with 48" long hose	T-35-4		\$76.00
Same as above, with 60" long hose	T-35-5		\$80.00



MOP HANGER	MODEL	SHIP WT.	LIST PRICE
Stainless steel, #4 finish. 24" long with 3 rubber spring loaded grips	T-40	2 lbs. — 1 kg.	\$60.00



SEALANT	MODEL	SHIP WT.	LIST PRICE
Silaprene Sealant in 1/12th U.S. gal. std. cartridge	C-10	1 lb. — .5 kg.	\$37.50

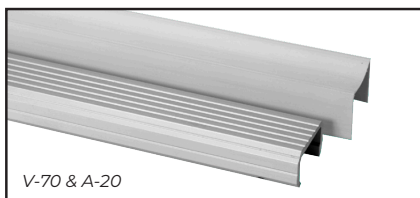

TERRAZZO REPAIR KIT	MODEL	SHIP WT.	LIST PRICE
	RK	2 lbs. — 1 kg.	\$220.92



BUMPER GUARDS	MODEL	SHIP WT.	LIST PRICE
Extruded Vinyl	V-70-24"	1 lb. — .5 kg.	\$52.04
	V-70-36"	2 lbs. — 1 kg.	\$61.25
Aluminum	A-20-24"	2 lbs. — 1 kg.	\$94.15
	A-20-32"	3 lbs. — 1 kg.	\$117.89
	A-20-36"	3 lbs. — 1 kg.	\$122.54

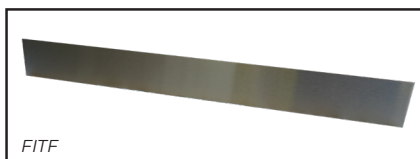

LINT BASKET	MODEL	SHIP WT.	LIST PRICE
	S223-0003	.5 lbs — .25 kg.	\$90.72

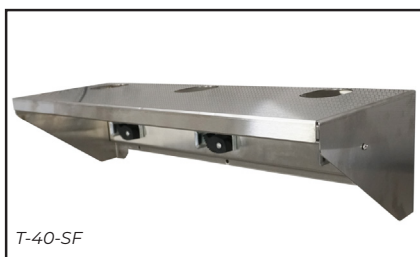

FIELD INSTALLABLE TILING FLANGE	MODEL	LIST PRICE
24" Flanges	FITF-24	\$40.00
36" Flanges	FITF-36	\$48.00

STAINLESS STEEL SHELF	MODEL	LIST PRICE
18 gauge stainless steel, #4 finish. 24." long with 3 rubber spring loaded grips. Stainless steel rod with large open hooks	T-40-SF	\$324.00

QUICK DRAIN CONNECTOR GASKET APPLICATIONS

GASKET	HEIGHT	O.D.	I.D.	USE WITH	STERN WILLIAMS APPLICATIONS
QDC4000	1.000	2.950	2.350	2.375 O.D. Pipe	Terrazzo Shower Floors (Standard)
QIC2000	1.000	3.050	2.270	2.375 O.D. Pipe	Terrazzo Shower Floors
QDC3XH000	1.240	4.480	3.400	3.5 O.D. Pipe	Terrazzo Mop Basins (Standard)
QDC3SN000	1.250	4.400	3.200	3.5 O.D. Pipe	Terrazzo Mop Basins
QDC32000	1.350	4.400	2.250	2.375 O.D. Pipe	Terrazzo Mop Basins

Outer diameter of pipe

PVC Sch 40		CIP Sch 40		Copper	Cast Iron
2"	3"	2"	3"	2"	3"
2.375"	3.500"	2.35 ±.09	3.35 ±.09	2.125"	3.300"

TERRAZZO FAQs

What is the standard color for mop sinks?

The standard color for mop sinks is Gray, which is made with white Portland cement with gray chips. For custom color options contact Stern-Williams customer service.

What is the standard color for shower floors?

The standard color for shower floors is Black and White, which is made with white Portland cement with black and white chips. For custom color options contact Stern-Williams customer service.

Is terrazzo repairable?

Surface crack or chips may be repairable with our repair kit (RK). Anything beyond a surface level repair please contact Stern-Williams customer service.

Custom order availability.

We can fabricate a wide range of custom options; Drain positions, overall size, integral stainless steel caps, or tiling flanges. Contact Stern-Williams customer service for custom options.

CONTACT

REPRESENTATION ACROSS THE UNITED STATES & CANADA

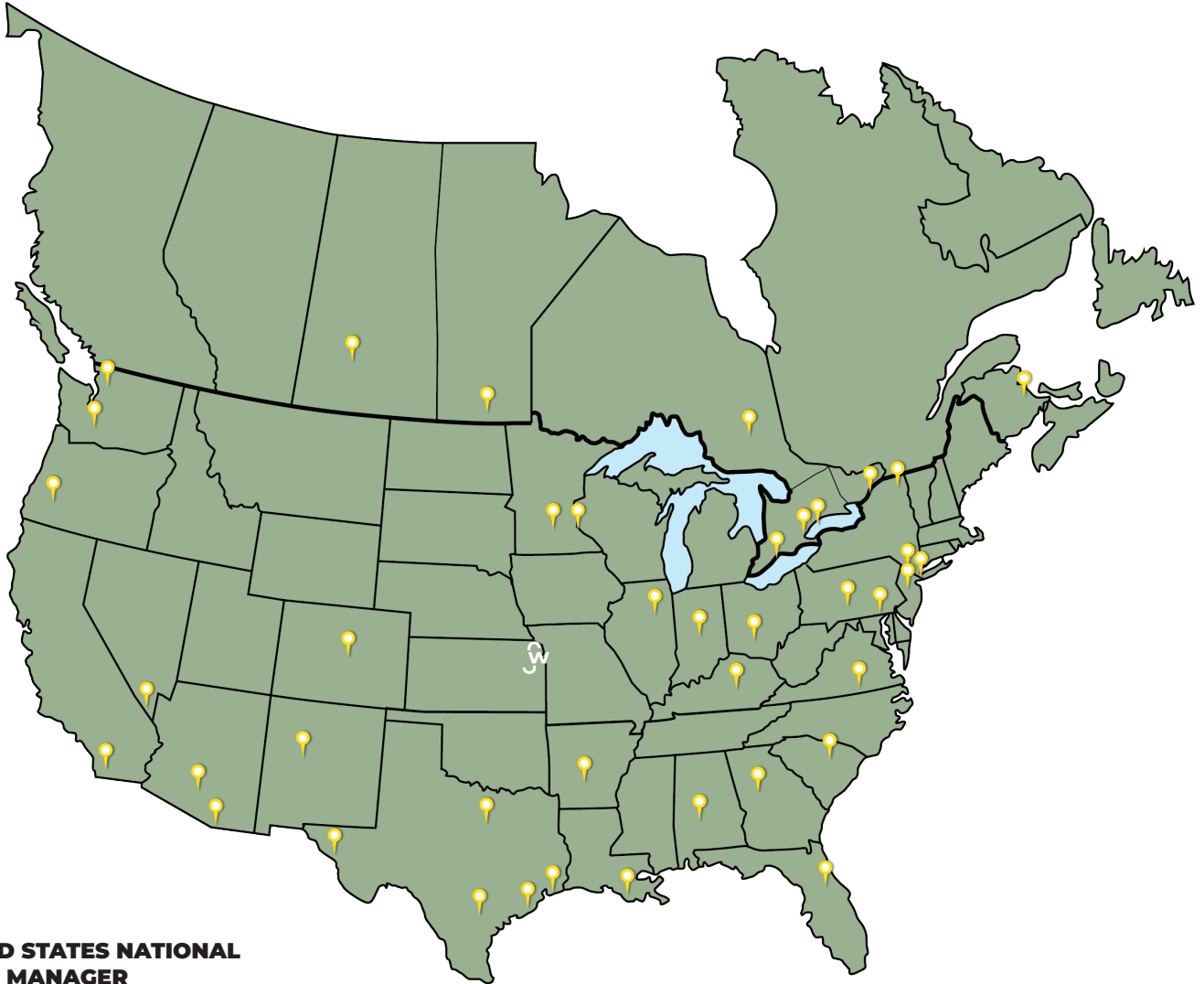

UNITED STATES NATIONAL SALES MANAGER

Jeff Kren
773-230-2644
jkren@sternwilliams.com

CANADA NATIONAL SALES MANAGER

Chad Neil
313-919-4197
cneil@prier.com

For order status, product or literature requests, email
orders@sternwilliams.com

Please specify the product line and the following:
Name, Company, and Address.

Visit **sternwilliams.com** for product brochures, spec
sheets, revit files, and other resources.

ADMINISTRATIVE OFFICE:

13920 Cypress Lane
Grandview, MO 64030

MANUFACTURING:

102 W. Main St.,
Carterville MO, 64835

CANADA WAREHOUSE:

590 South Service Road, Unit 2,
Hamilton, ON L8E 2W1, Canada
Seaman St Entrance – Dock 3



STERN-WILLIAMS

MADE IN USA

sternwilliams.com